

- ALL DIMENSIONS IN METRES UNLESS OTHERWISE NOTED. DO NOT SCALE.
- ALL LEVELS IN METRES AND REDUCED TO ORDNANCE DATUM UNLESS OTHERWISE NOTED.
- FOR LAYOUT SEE DRAWING 60541587-SHT-20-PHZ4-C-2160 & 2161.
- SUDS FEATURES TO BE CONFIRMED FOLLOWING DETAILED GEOTECHNICAL AND HYDRAULIC INSTIGATION
- DRAINAGE CONNECTION TO BE CONFIRMED DURING DETAIL DESIGN
- ALL PROPOSED PIPE WORK ASSUMED TO BE 225mm. TO BE CONFIRMED DURING DETAIL DESIGN.
- LOCATION OF EXISTING SERVICES TO BE CONFIRMED PRIOR TO DETAILED DESIGN
- OPERATIONS ARE FULLY DESCRIBED IN SECTION 5 OF SCHEME DESCRIPTION DOCUMENT.
- THESE DRAWINGS ARE PROVIDED IN ACCORDANCE WITH THE REQUIREMENTS OF SECTION 60 AND SCHEDULE 2 OF THE FLOOD RISK MANAGEMENT (SCOTLAND) ACT 2009 AND PART III OF THE FLOOD RISK MANAGEMENT (FLOOD PROTECTION SCHEMES, POTENTIALLY VULNERABLE AREAS AND LOCAL PLAN DISTRICTS) (SCOTLAND) REGULATIONS 2010.

ISSUE/REVISION

I/R	DATE	DESCRIPTION
0	01-08-2018	ISSUE

PROJECT NUMBER

60541587

SHEET TITLE

SURFACE WATER  
MANAGEMENT  
TYPICAL LANDSCAPED  
DEPRESSION (DETENTION BASIN)  
SHEET NUMBER

60541587-SHT-20-PHZ4-C-2162

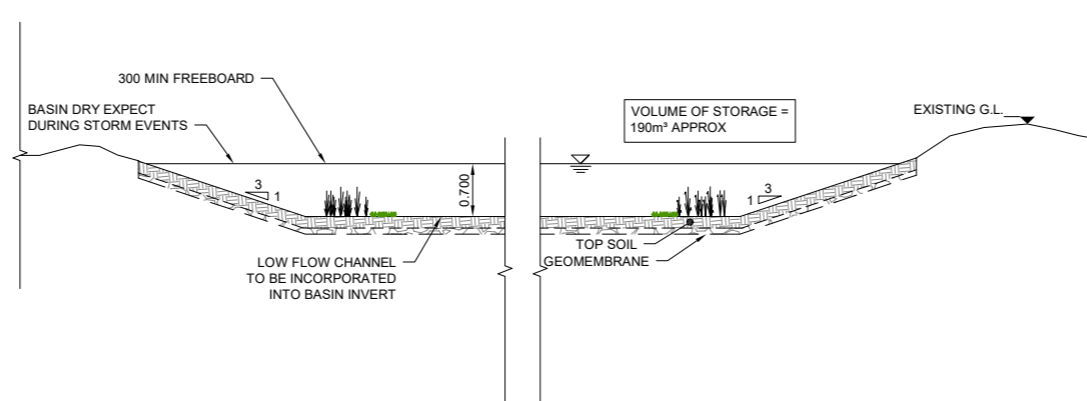

**A TYPICAL BASIN SECTION**

LAYOUT 1:10

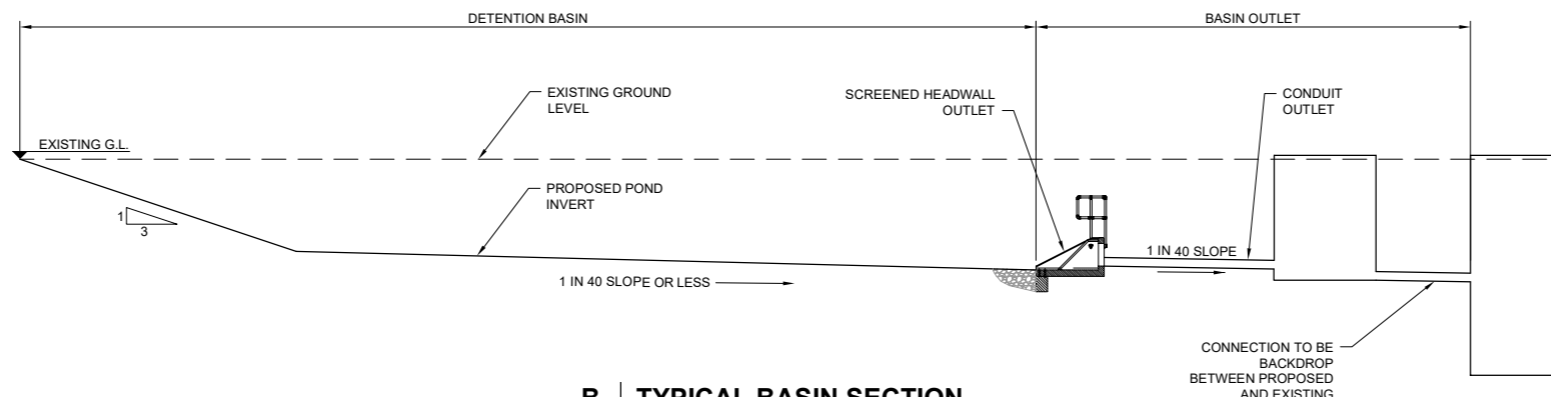

**B TYPICAL BASIN SECTION**

LAYOUT 1:50

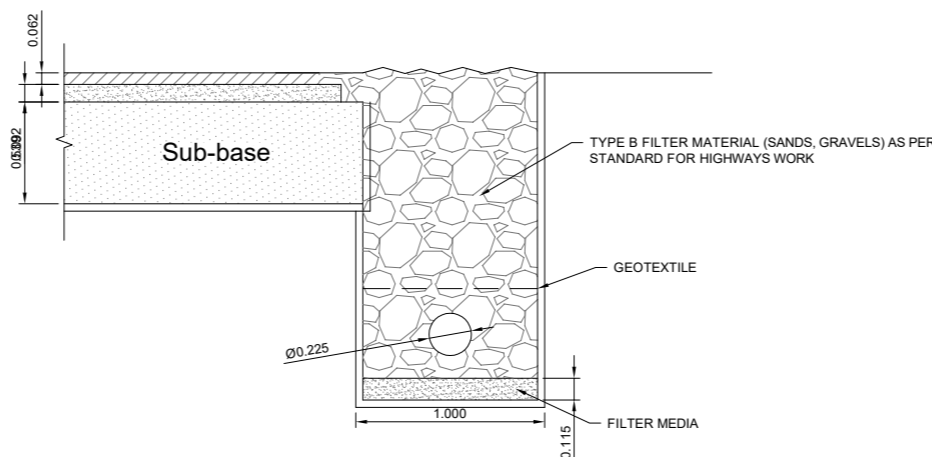

**C TYPICAL FILTER DRAIN SECTION**

LAYOUT 1:20

This drawing has been prepared for the use of AECOM's client. It may not be used, modified, reproduced or relied upon by third parties, except as agreed by AECOM or as required by law. AECOM accepts no responsibility, and denies any liability whatsoever, to any party that uses or relies on this drawing without AECOM's express written consent. Do not scale this document. All measurements must be obtained from the stated dimensions.

NOT FOR CONSTRUCTION