



LAND REGISTER OF SCOTLAND



KILLEAN FARM HOUSE, INVERARAY, PA32 8XT

Survey scale 1:2500

Print scale 1:2500 @ A4

30/04/2021

REQUEST NUMBER 5133691ARG

204717 704243 205176 704771

CROWN COPYRIGHT © This copy has been produced on 30/04/2021 with the authority of Ordnance Survey under Section 47 of the Copyright and Patents Act 1988. Unless there is a relevant exception to copyright, the copy must not be copied without prior permission of the copyright owner. OS Licence no 100041182.
This extract may contain Ordnance Survey features captured at other scales.

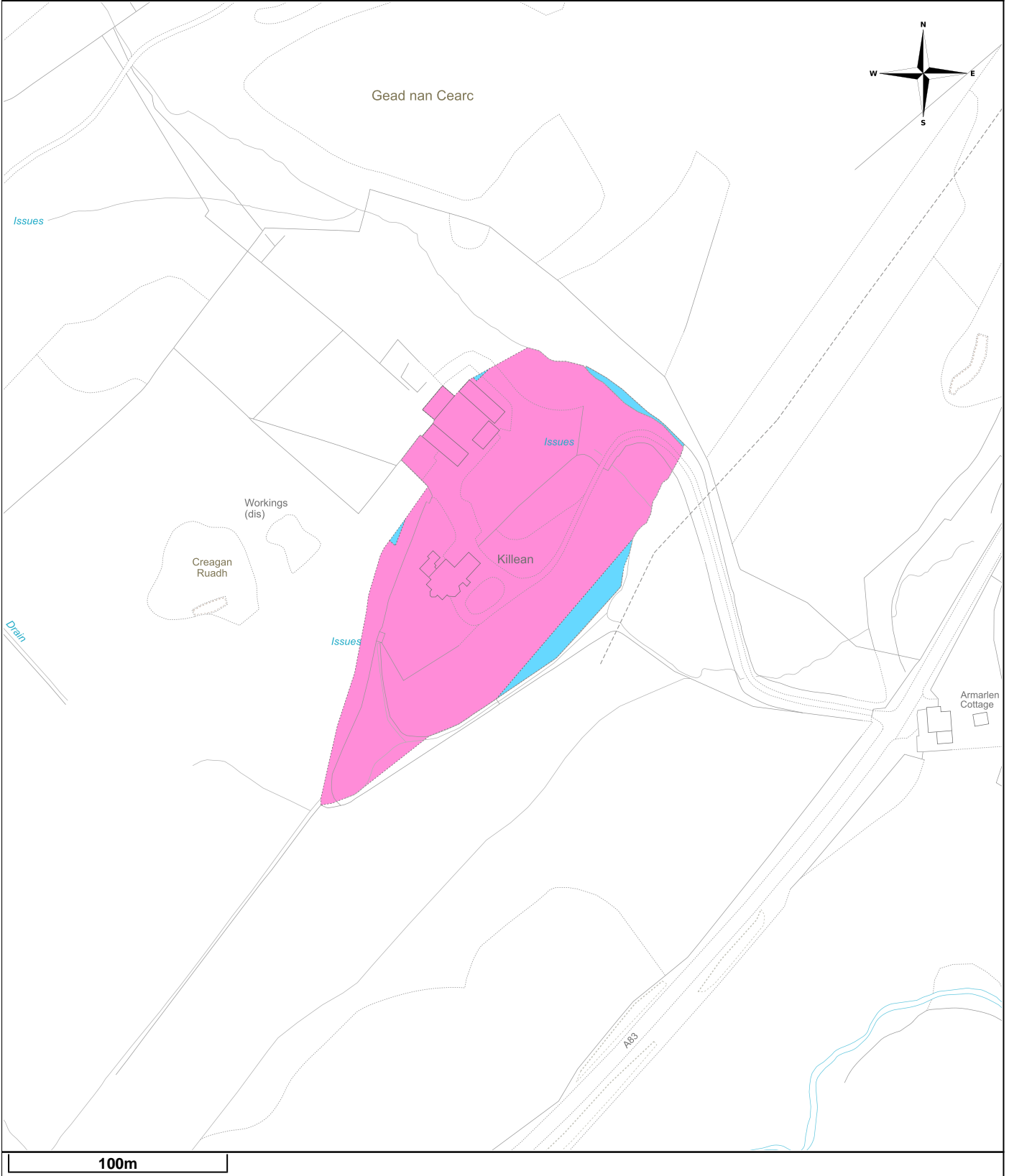

04800

04900

05000

SITE MAP



Region WEST			
Subject Land at Killean			
Scale AS SHOWN	RoS County ARGYLL	Prepared By DO	24/06/21
1:50,000 No. 56	Drg. No. 2021-048	Revised By	
Sheet No's NN00SE,SW.	District WEST ARGYLL	Print Size - A3	
NGR NN04860460	Reproduced by permission of Ordnance Survey on behalf of HMSO. © Crown copyright and database right 2021. All rights reserved. Ordnance Survey Licence number 100024925.		

Draft Map

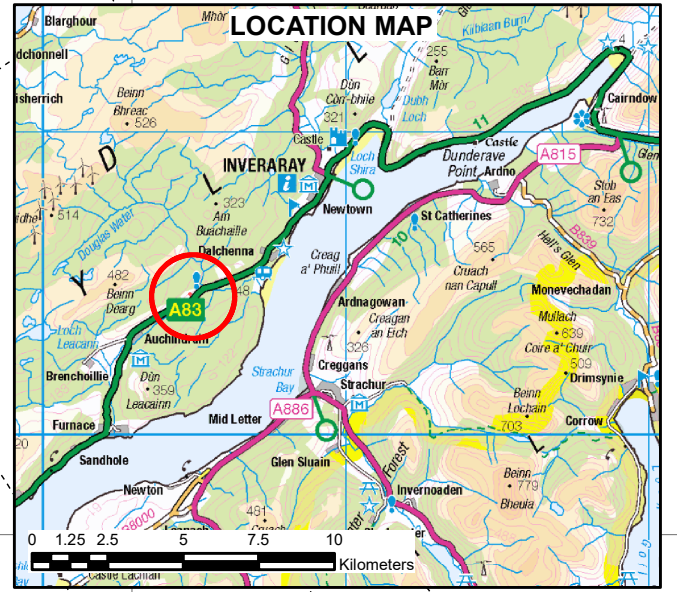

04700

04700

04600

04600

04500

04500

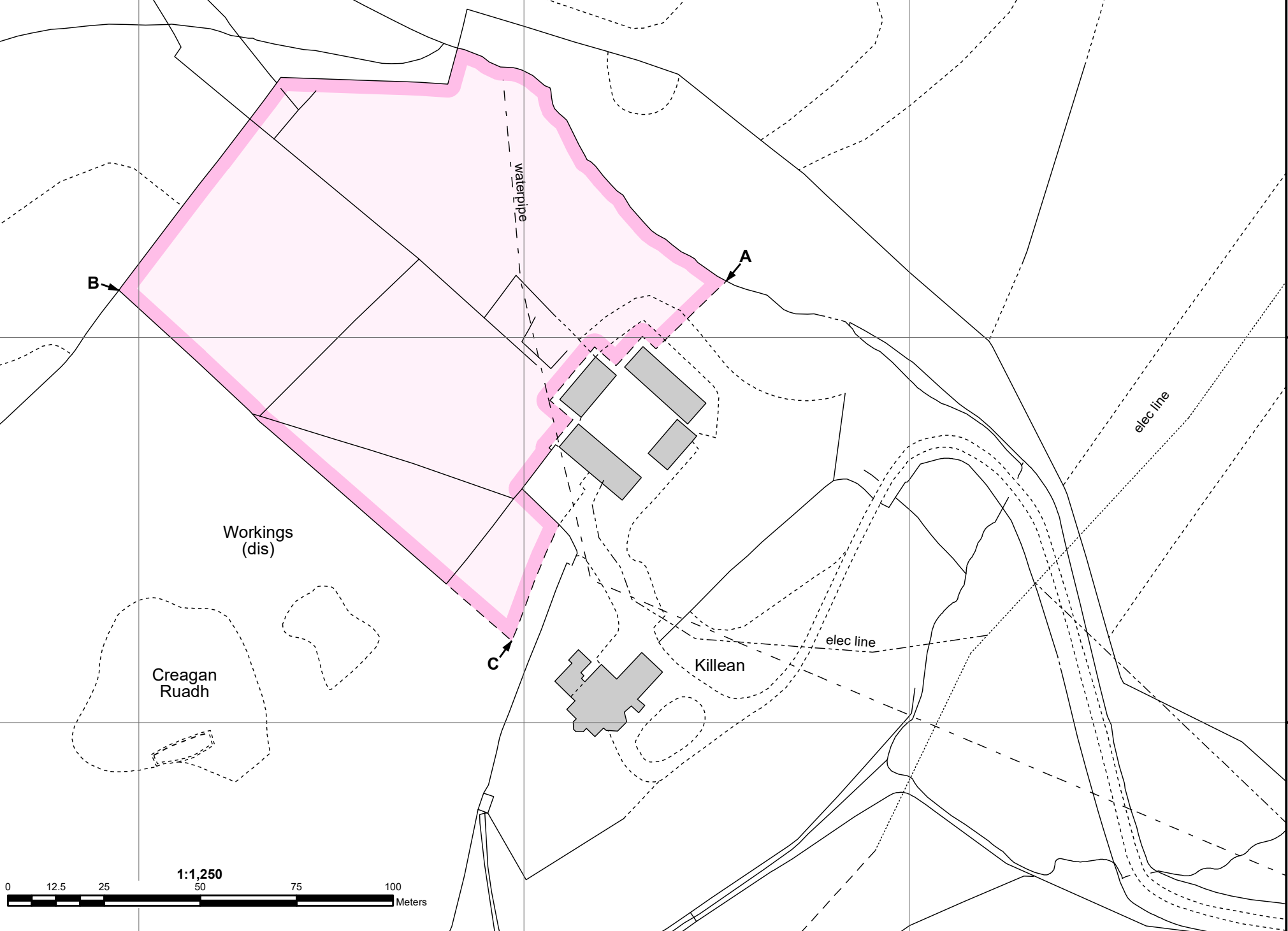

04400

04400

04000

04000

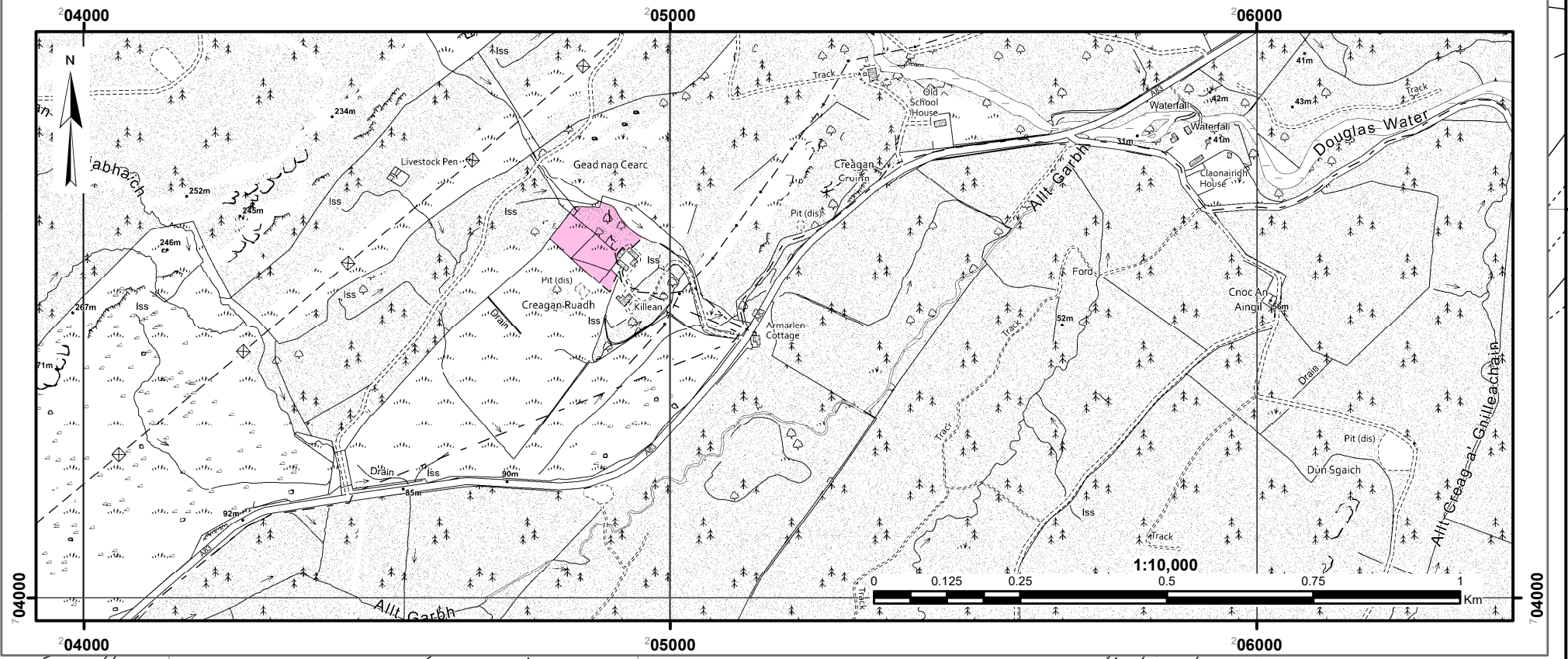

04800

04900

05000